

Hinge 80 MF DH66 (V4A)

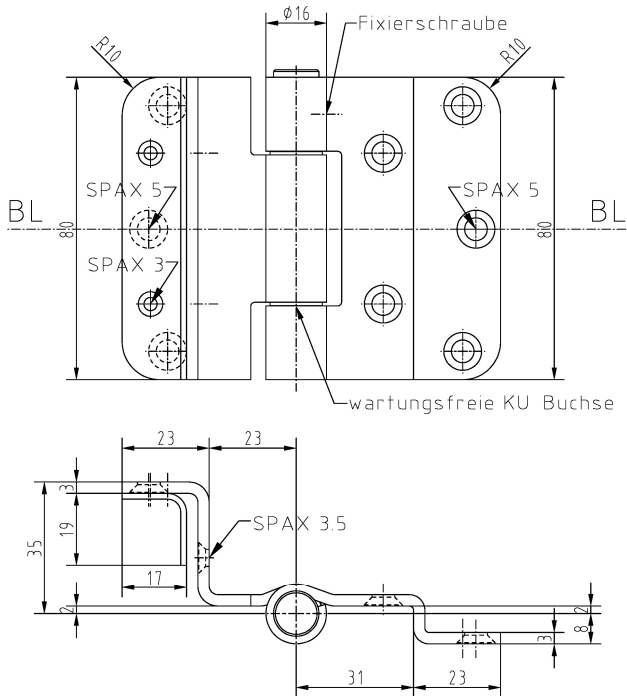

Additional Information

Standard load: Maximum door weight 80 kg (per pair)
 Application: Hinge for non-rebated wooden doors or windows, maintenance-free, with security pin
 Accessories: Decorative head and other finishes available

Section Drawing

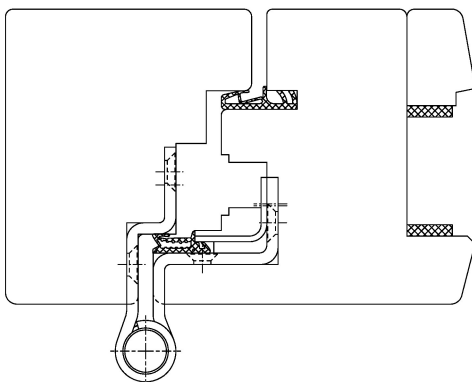

Item	Finish	PU
040067	enox brushed	30