

Retrofit Set Receiver ST84

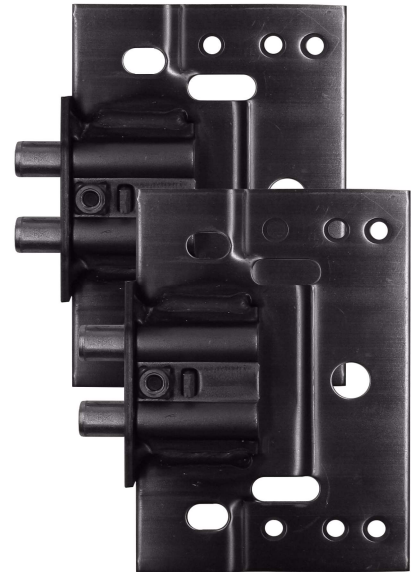
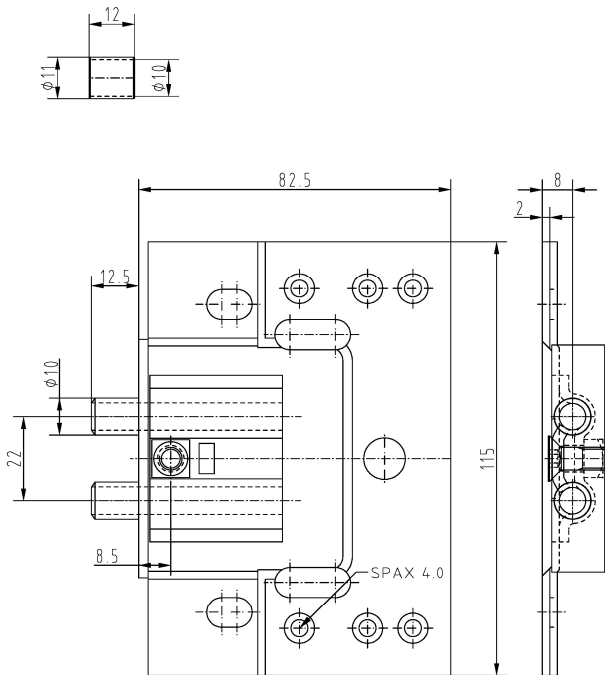

Additional Information

Standard load: Maximum door weight 70 kg (per pair)
Application: Retrofit set for heavy receiver in wooden case frames, prepared for attachment to the wall; available as a set with 2 receivers, screws, a drilling template are included. Also 4 plastic bushings for compensating differences in case holes.
Accessories: COMBICA ® frame parts 1534, 1544, 2641, 2941

Section Drawing

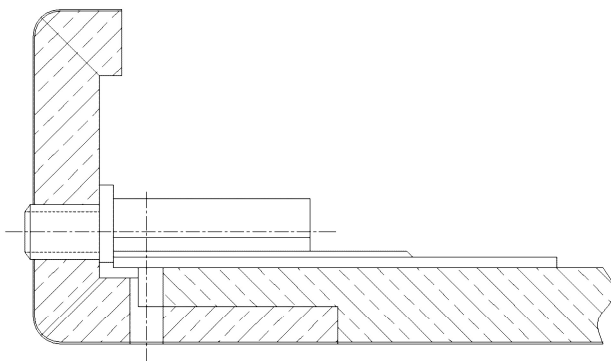

Item	Finish	PU
040037	zinc plated	1