

Safety Plate (A-N)

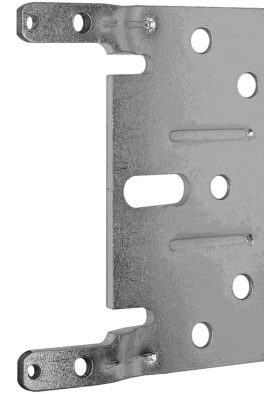
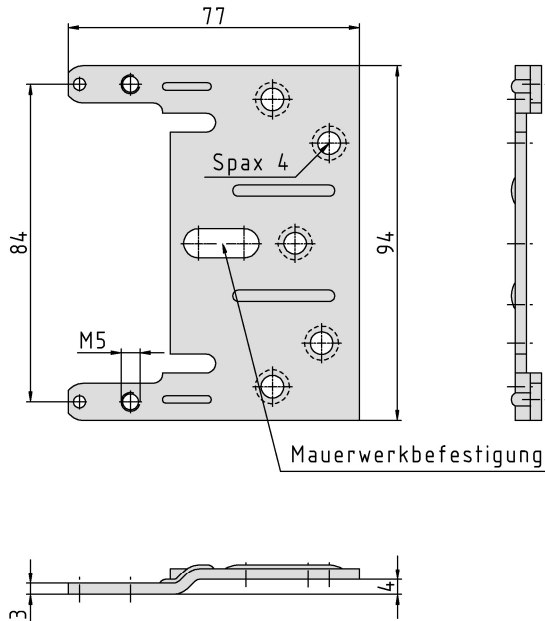

Additional Information

System: HS
 Application: Safety plate for rebated doors, double shell frames, the safety plate is screwed from the back and can be fixed to the wall if required; the striking plates are screwed into the solid bushings; suitable for heavy duty doors according to RC2 or RC3
 Compatibility: A-N

Section Drawing

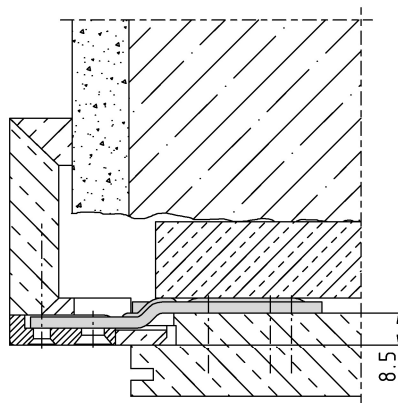

Item	Finish	PU Remark
040101	zinc plated	40 SI-Blech Schließblech 106 mm