

Additional Information

System: 3
 Application: Safety plate for rebated doors, double shell frames, the safety plate is screwed from the back and can be fixed to the wall if required; the striking plates are screwed into the solid bushings; suitable for heavy duty doors according to RC2 or RC3
 Compatibility: C-N

Section Drawing

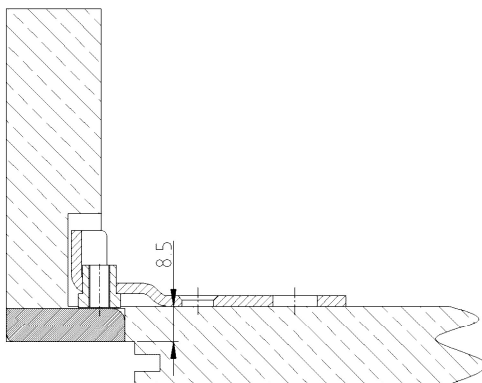

Item	Finish	PU Remark
022736	without finish	100 SI-Blech für 1-Loch SBL H=8,5mm