

Main Locking Plate, light, non-rebated

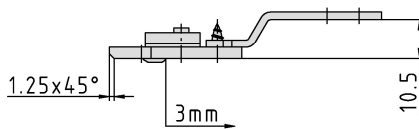
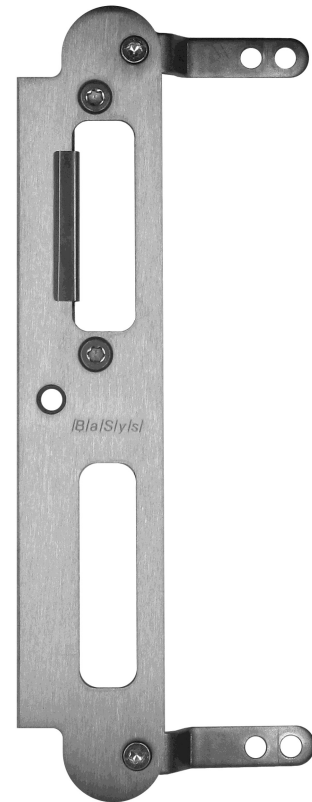
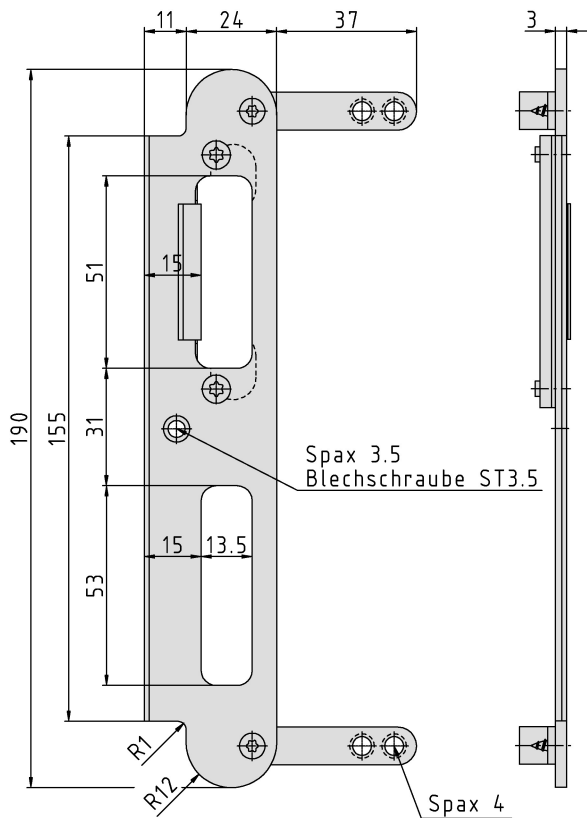

dargestellt: DIN-Rechts

Additional Information

System: GN
Application: Striking plate system for non-rebated doors, has to be recessed, suitable for all DIN norm locks; contact pressure seal adjustable (3 mm)
Compatibility: plastic lining with reference C for door handle latch; safety plates with reference A-H

Section Drawing

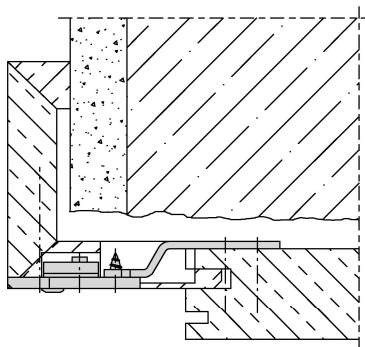

| Item | Finish | PU Remark |
|--------|--------------|--------------------------------|
| 040500 | enox brushed | 70 SBL Nr.64 justierbar V3, LS |
| 040501 | enox brushed | 70 SBL Nr.64 justierbar V3, RS |