

Main Locking Plate, light, rebated

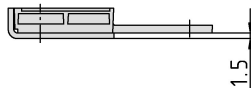

dargestellt: DIN-Rechts

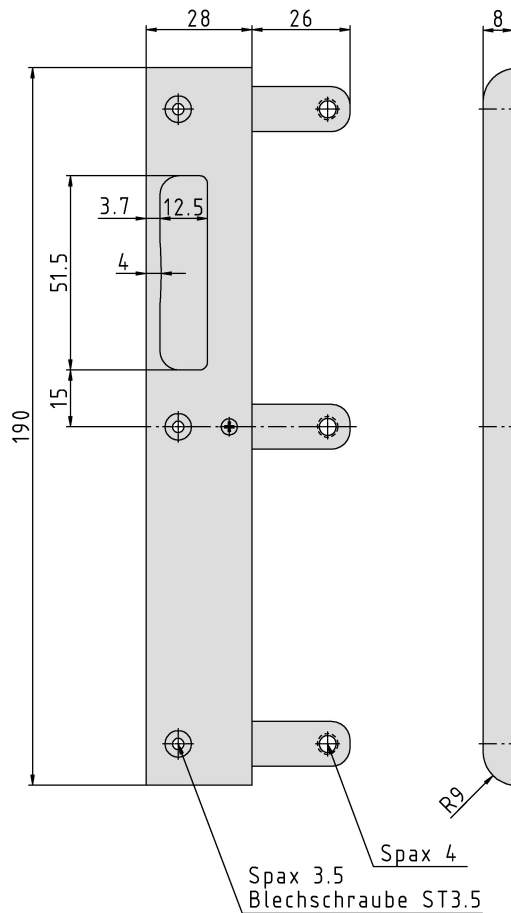
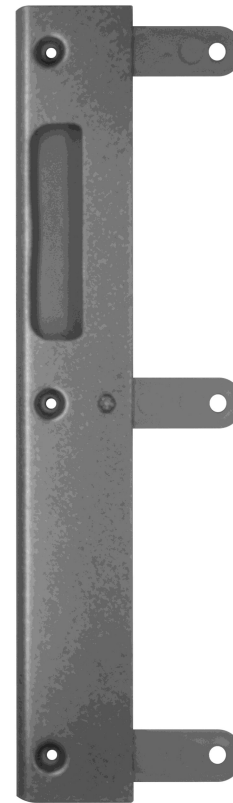

Additional Information

System: HS
Application: Striking plate system for rebated doors has to be recessed, suitable for all DIN locks;
Note: the external dimensions correspond to those of solid striking plates (System1) so that the striking plate fits into the same recess

Section Drawing

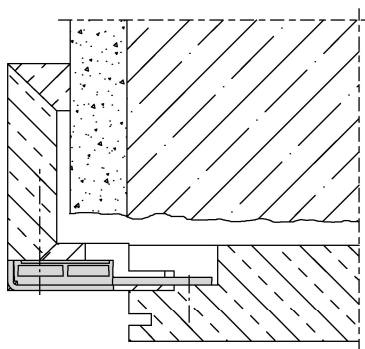

Item	Finish	PU Remark
040085	new silver	70 SBL 190 mm 1-Falle leicht m. KU LS
040087	gold plated	70 SBL 190 mm 1-Falle leicht m. KU LS
040089	enox brushed	70 SBL 190 mm 1-Falle leicht m. KU LS
040238	white coated	70 SBL 190 mm 1-Falle leicht m. KU LS
040086	new silver	70 SBL 190 mm 1-Falle leicht m. KU RS
040088	gold plated	70 SBL 190 mm 1-Falle leicht m. KU RS
040090	enox brushed	70 SBL 190 mm 1-Falle leicht m. KU RS
040239	white coated	70 SBL 190 mm 1-Falle leicht m. KU RS