

**Main Locking Plate, light, rebated**

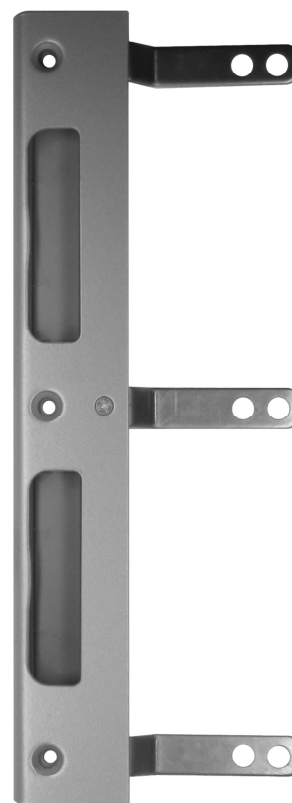

**Section drawing**

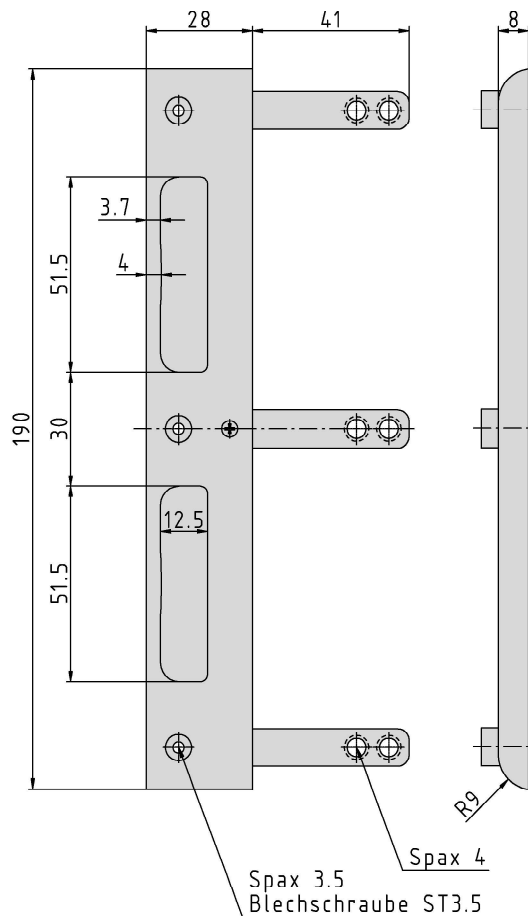
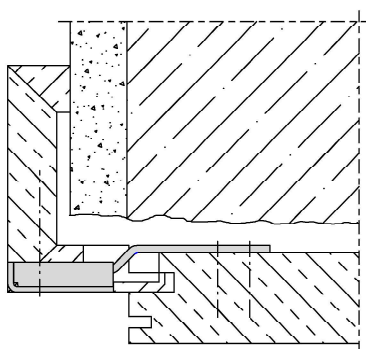

**Additional Information**

- System: GN  
 Application: Striking plate system for rebated doors, has to be recessed, suitable for all DIN locks;  
 Note: the external dimensions correspond to those of solid striking plates (System1) so that the striking plate fits into the same recess  
 Compatibility: Safety plates with reference A-H

item no.	Finish	PU
040474	enox brushed	60
040475	silver colour	60
040641	gold plated	60