

OBJECTA® STV123/56 3-D

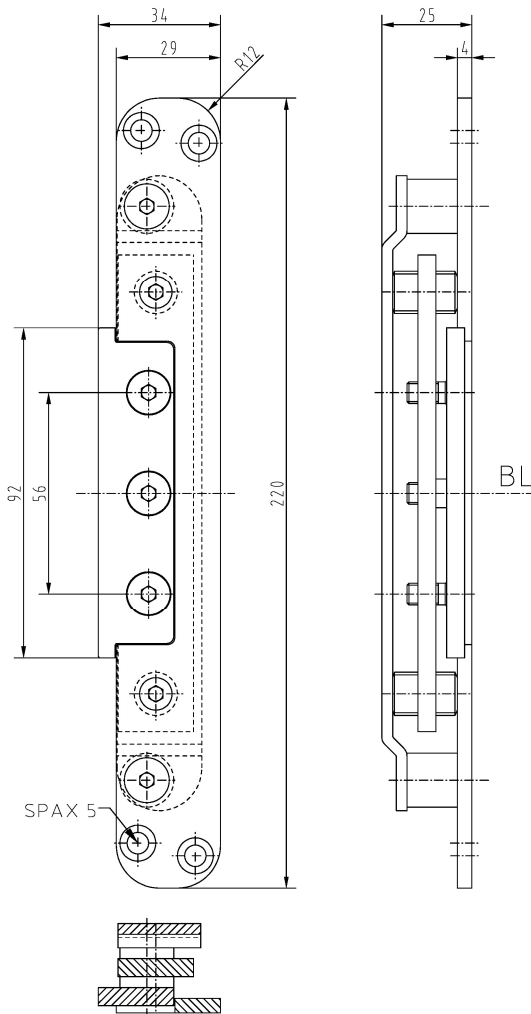

Additional Information

Standard load: Maximum door weight 150 kg (per pair)
 Application: 3-dimensionally adjustable receiver for non-rebated doors; applicable in wooden frames; can also be mortised into the leaf (alternatively), therefore suitable for extremely small frame breadths
 Combination: OBJECTA® 2029/120/56 D15, 2029/160/56 D15, 2029/120/56 cr. 15 mm, 2029/160/56 cr. 15 mm

Section Drawing

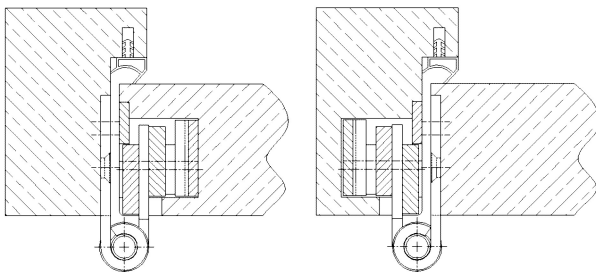

Item	Finish	PU
039073	enox brushed	20