

Additional Information

Standard load: Maximum door weight 100 kg (per pair)

Application: Complete hinge with fixing screw for non-rebated doors; door part has to be recessed into the door; slim design due to **15 mm barrel diameter**

Combination: OBJECTA® 3-D receiver STV120/56 and with connection size 56 mm (VX).

Section Drawing

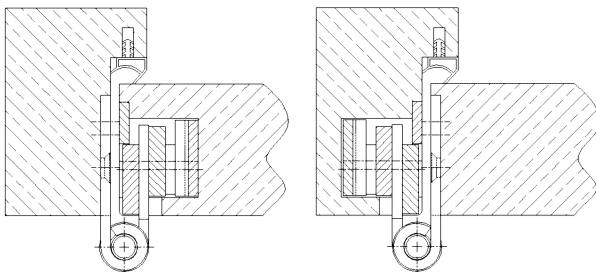

Item	Finish	PU
039243	enox brushed	30